

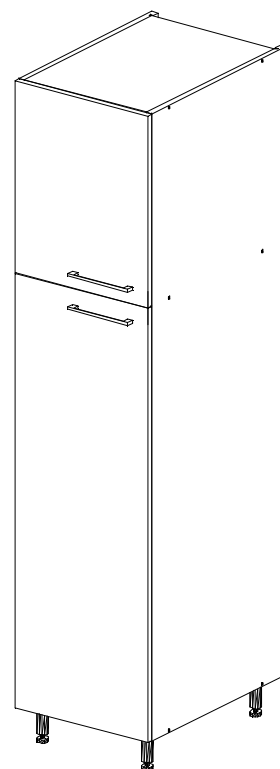

N/203/45/2A

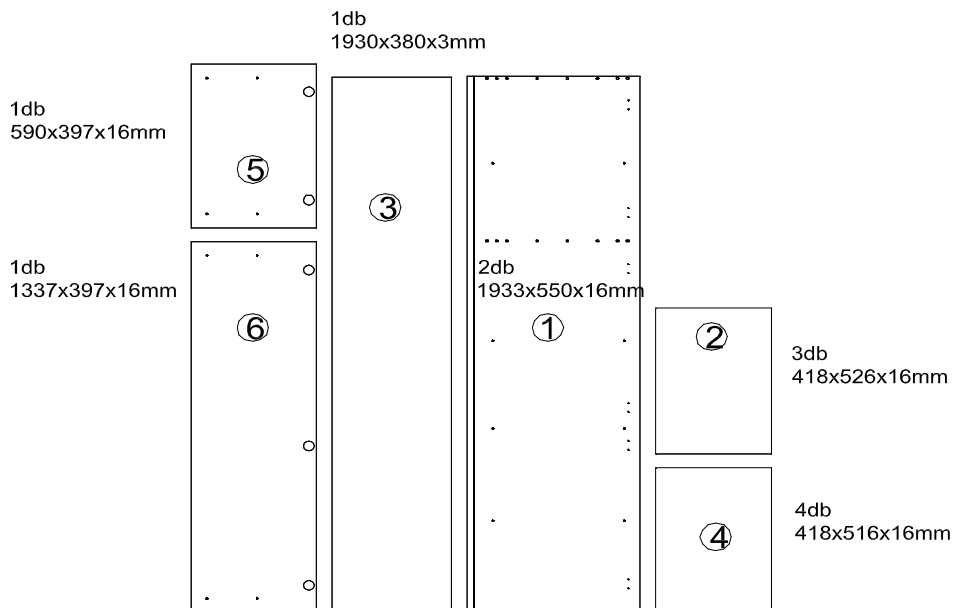

| | | |
|---|---|--|
| KO 01 8*30 36 X  | KN 03 7*50 12 X  | PL 12 12 X  |
| UC 11 (160 mm) 2 X  | DR 27 3,5*16 40 X  | PL 01 1 X  |
| PP 01 16 X  | PN 01 5 X  | PD 01 5 X  |
| KV 01 1,5*20 30 X  | UC 06 4*30 4 X  | KL 01 4 mm 1 X  |
| DD 55 4 X  | DR 25 4*25 2 X  | |

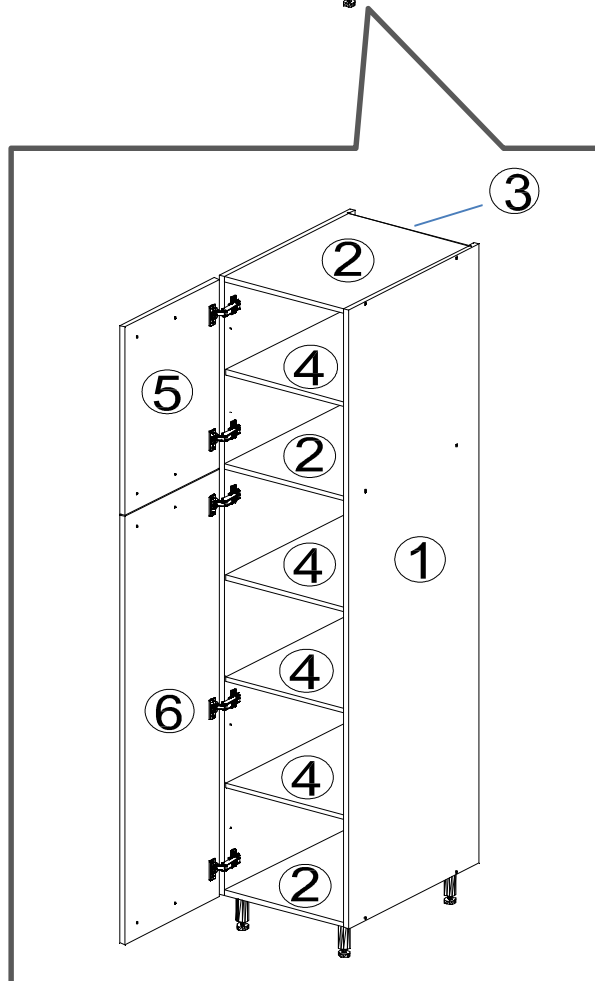

Az elemek megfelelő stabilitása és baleset megelőzés céljából, az elemeket célszerű egymáshoz rögzíteni egy rejtett pozícióban a (DR 25 4*25) facsavarral!

1.

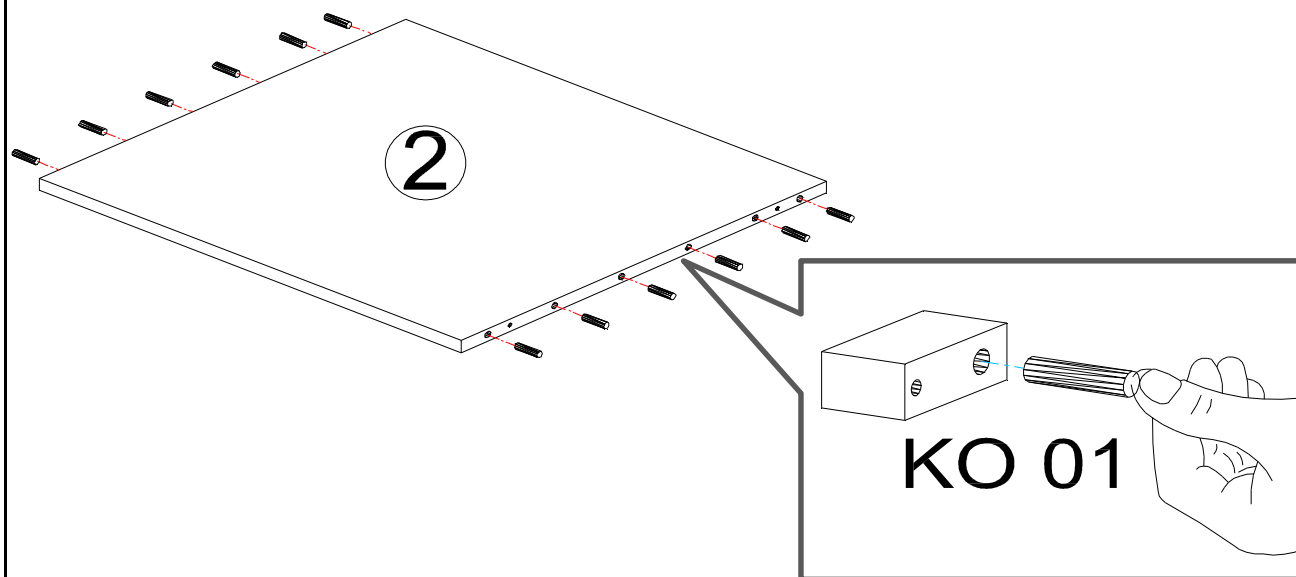

2.

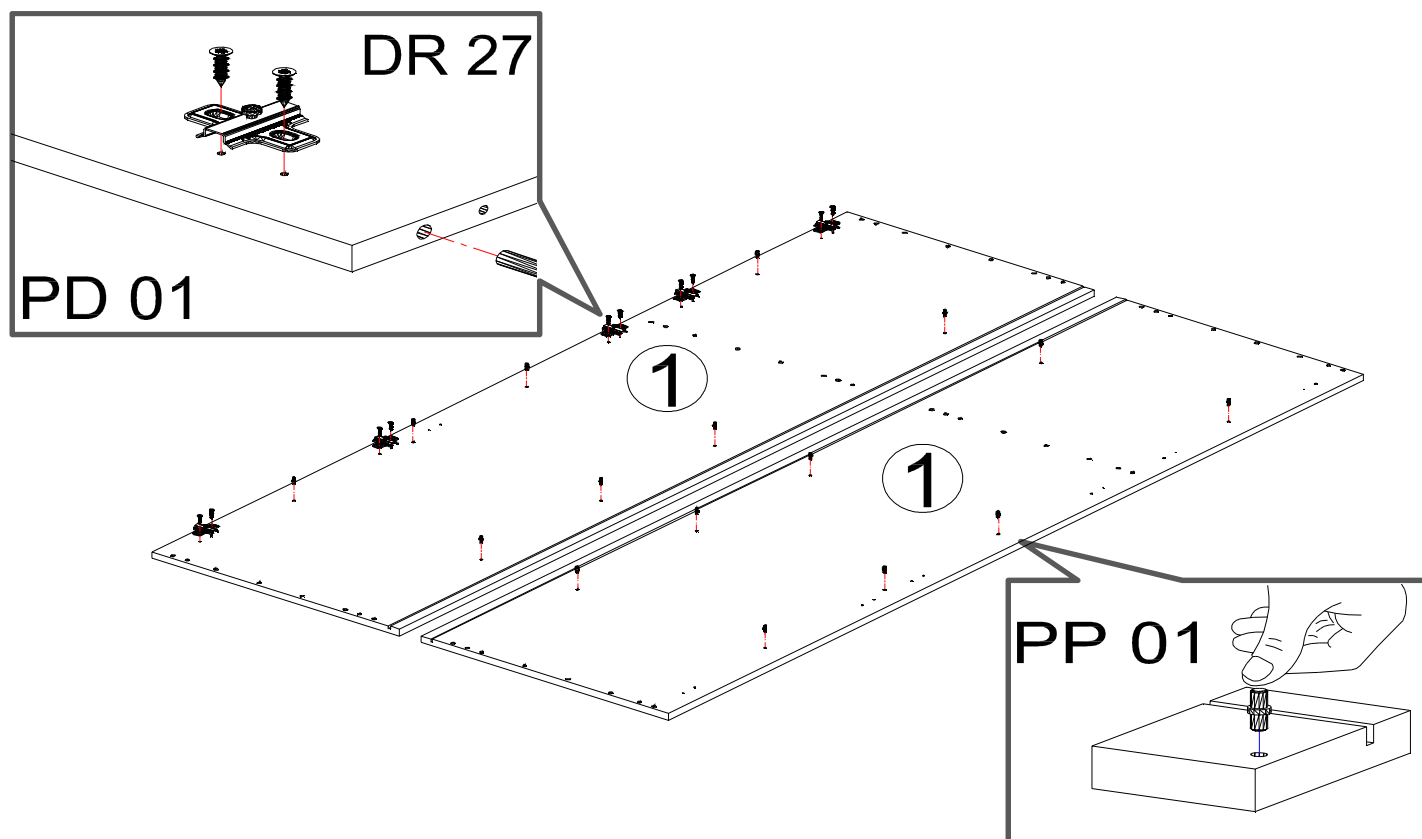

3.

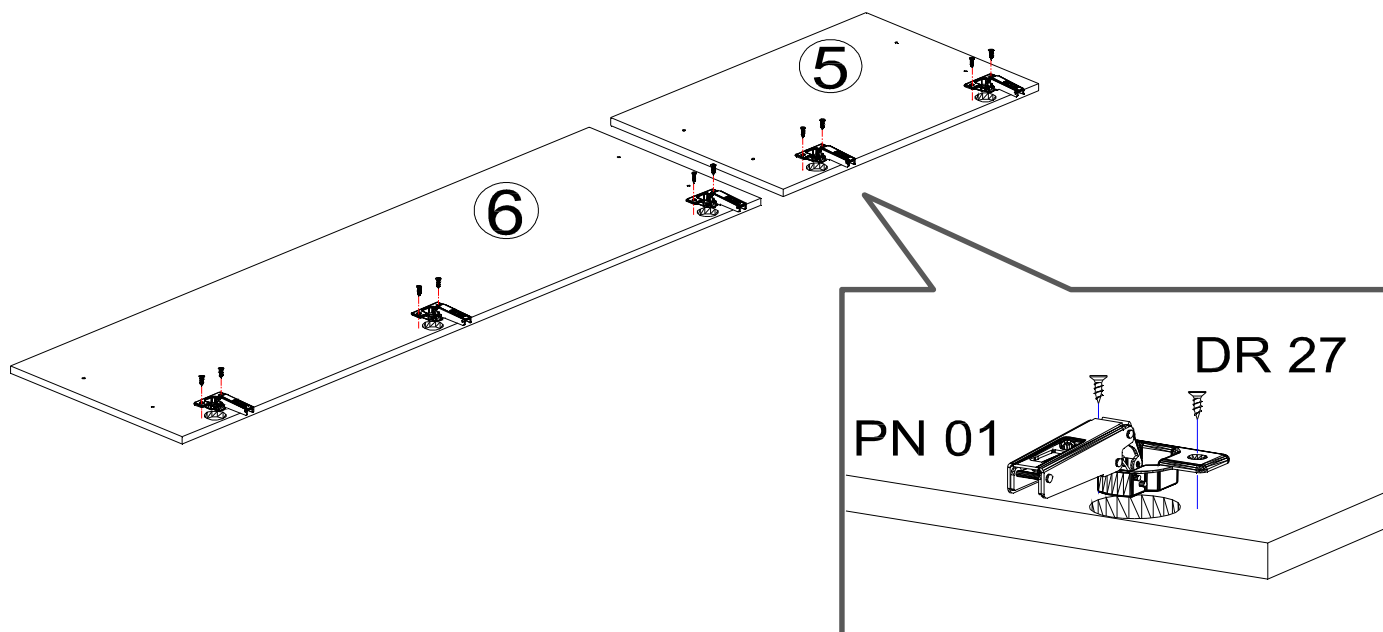

4.

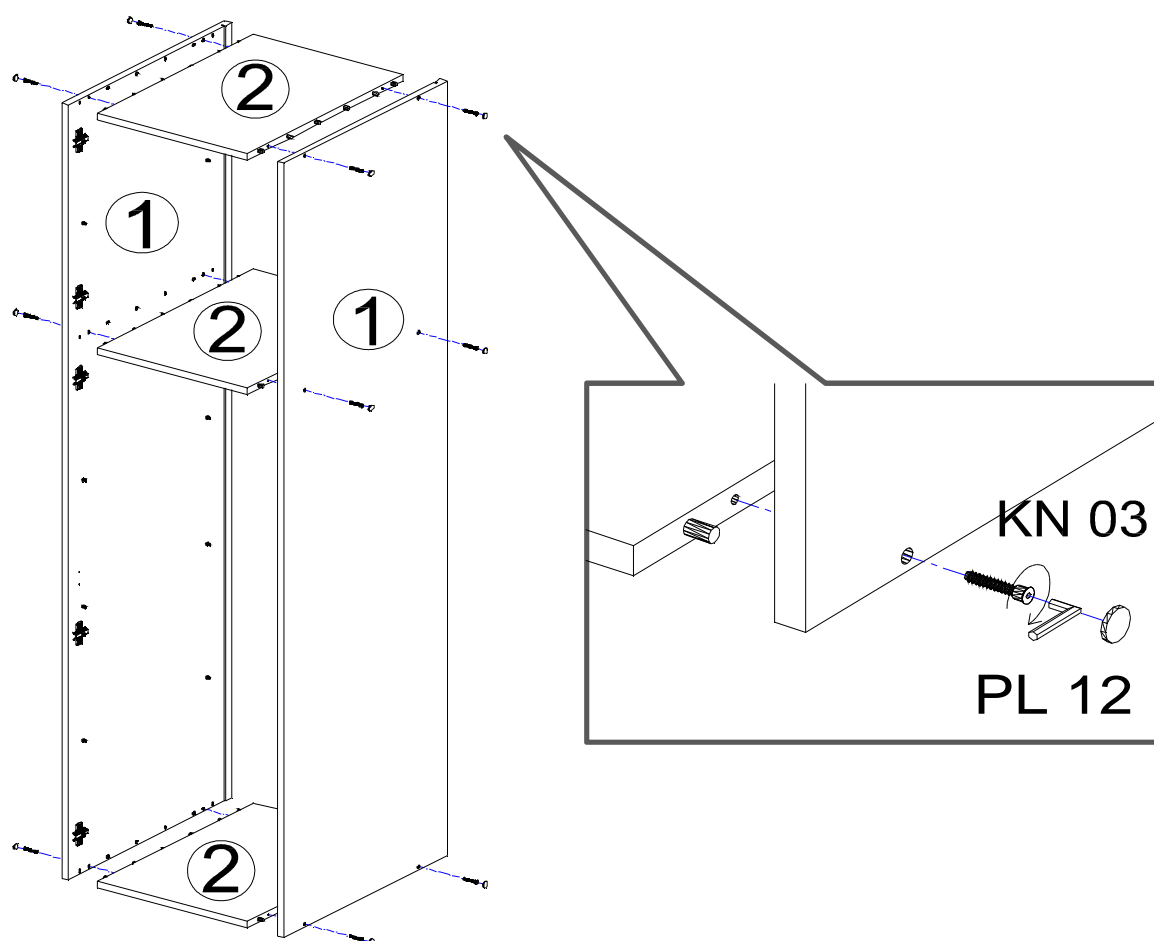

5.

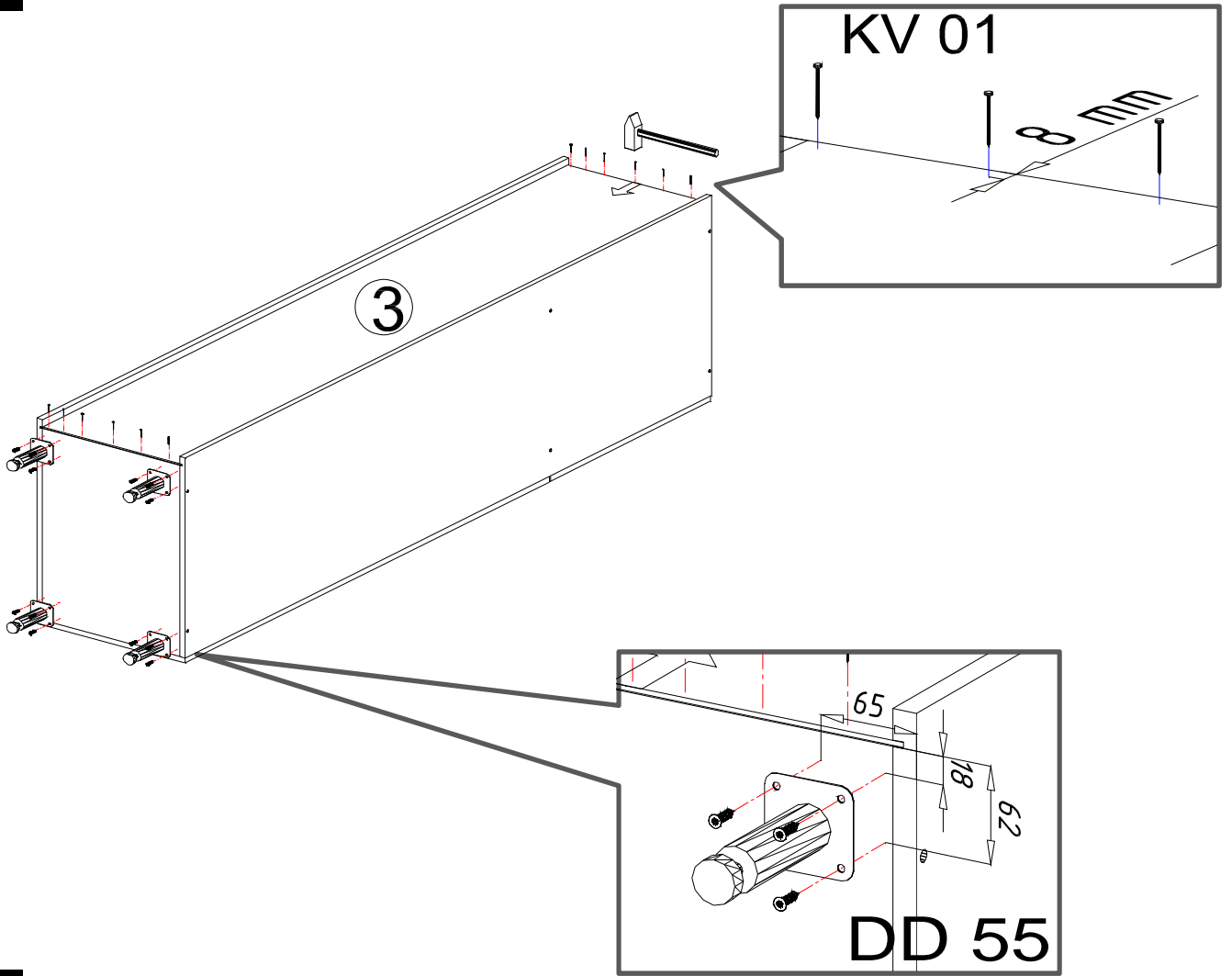

6.

