

Camargue[®] vario

Achtung ! Gläser niemals ungeschützt auf den Boden stellen.
Verletzung der Glaskante führt zu Glasbruch.

Caution ! Never put glass walls on the floor without protection.
Damaging the glass edges results in breaking of the glass.

Attention ! Jamais placer des parois de douche en verre au sol sans protection. Des verres endommagés casseront.

HK 01/2013

S10 / W10

S11 / W11

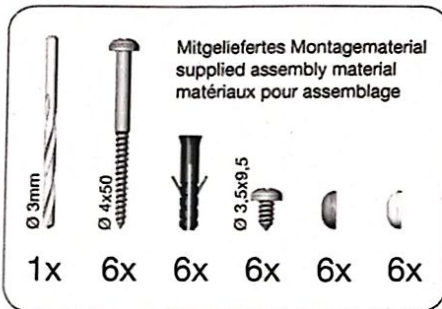
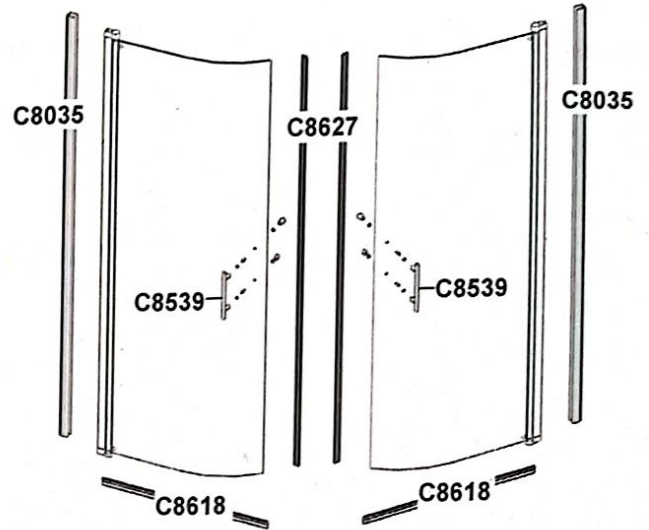

1

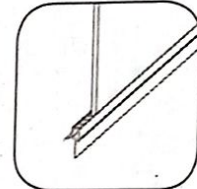
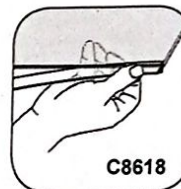

2

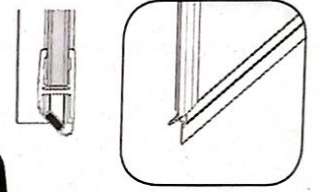
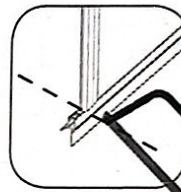
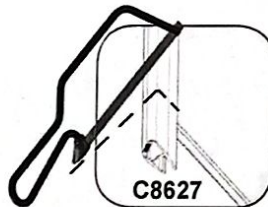
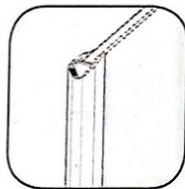
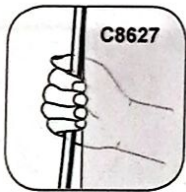

C8627: immer auf Unterseite abschneiden
always cut from the bottom
toujours couper par le bas

3

Modell	Duschlassen-Einbaumaß Shower tray installation dimensions Dimensions de montage bacs de douche (mm)	Bodengleicher Aufbau Ground level installation Pose au sol d1 (mm)
S10 / W10	885 - 905	845 - 865
S11 / W11	985 - 1005	945 - 965

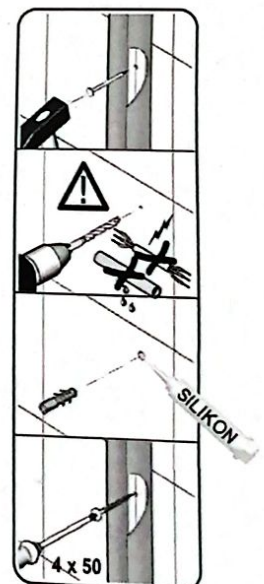
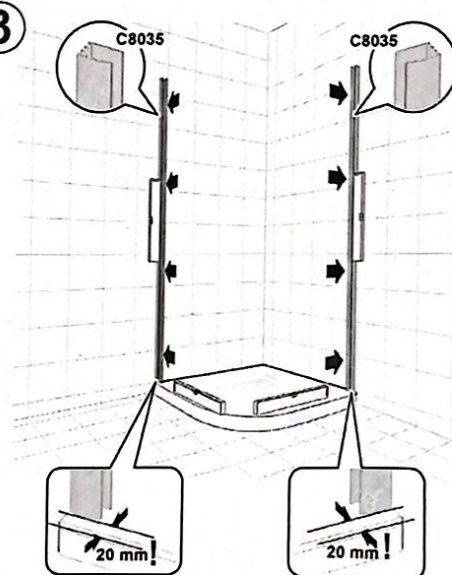
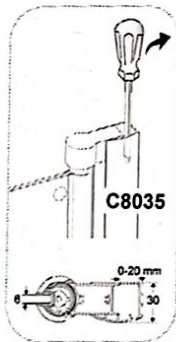

Hergestellt für:
BAHAG AG
Gutenbergstr. 21
68167 Mannheim

